



PROTON has been designed to provide power and USB fast charging (TUF-PD) in its simplest form. TUF-PD USB fast charging incorporates the latest power delivery technology and is also available as the replaceable option TUF-R.

Designed for panel mounting, the PROTON presents a single or double outlet module in a stylish matt silver, matt black, gloss black or a chrome decorative bezel.

For ease of installation PROTON is supplied prewired with either a 3 pin plug or a Wieland GST connector.

PROTON can be configured to provide combinations of power, TUF-PD or TUF-R USB fast charging and data / AV as required.

Proton single comes with a shutter lid option which closes when not in use.



- Power
- USB Fast Charging
- Data / AV

Common Units*

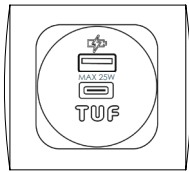

TUFA+C: Twin USB
Fast charger

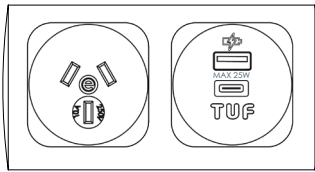

Australia / New Zealand and
TUFA+C: Twin USB Fast charger

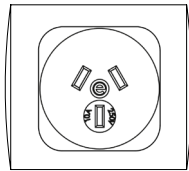

Australia / New
Zealand

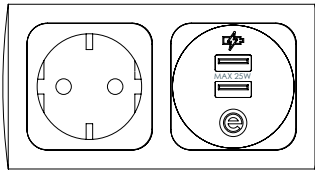

Schuko and TUFA+C: Twin USB
Fast charger

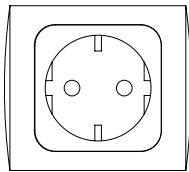

Schuko

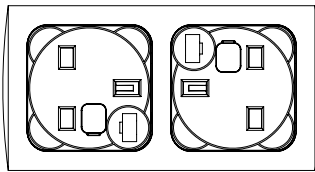

2 X UK Fused GPOs

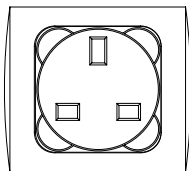

UK Unfused

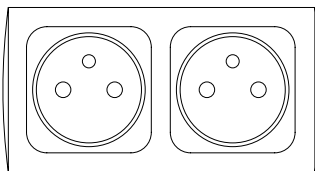

2 x French / Belgium

*see website for more

Unit dimensions

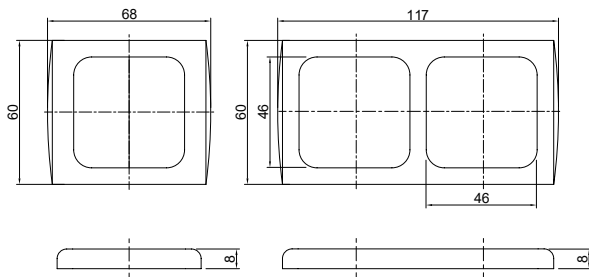

Cut-out dimensions

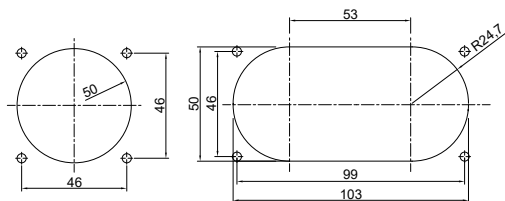

Mounting details

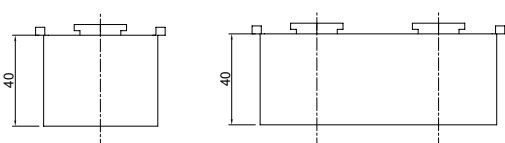

Features

Configuration:

Single outlet units: power only / USB charging only / Data/ AV only

Double outlet units: AC power only / USB charging only or Data/AV only. / Combined AC power, USB fast charging and/or Data/AV

NB: UK fused sockets can only be fitted in double outlet units.

Socket Types:

AUS/NZ 10A, 15A and Round Earth

NB: Other country sockets available, please see website for details

Colours:

Socket fascias: Matt black, white, grey and red

Decorative bezels: Matt silver, matt black, gloss black or chrome

Bezel with lid: Gloss Black

Testing:

All PROTON units are 100% tested before despatch

Fixings:

PROTON units can be snapped into 16mm panels or screw fixed into any suitable surface.

Shuttered fascia

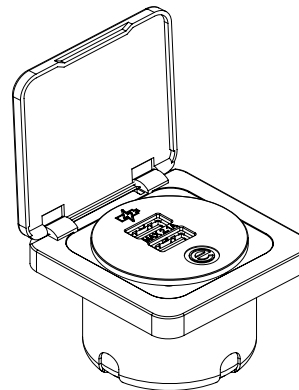

Cable outlet positions

